



Outram Park Information Kit

Version 3.0
October 2015

Table of Content

Table of Content	Page
A. General	
- Table of Content	2
- System map	3
B. Station Information	
- Station Contacts & Overview	4
- Taxi & General Contacts	5
- Station Layout	6-9
- Locality Map	10
- Bus Services (By Bus Stop)	11
- Places of Interest	12
- Train Service Disruption Leaflet	13-16



MRT

LRT

System map

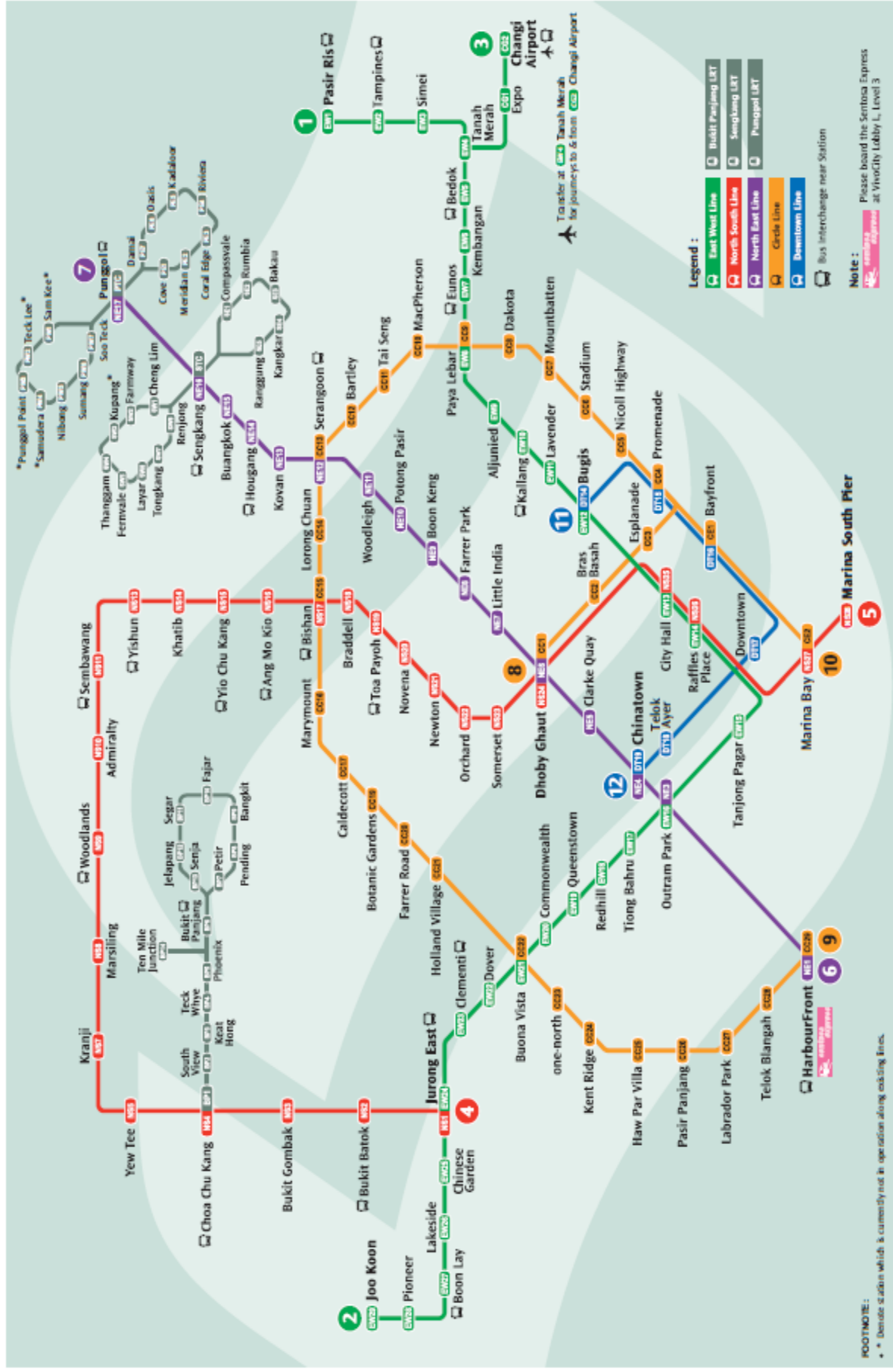

Station Overview

Station Contact Points	Contacts
Duty SM Hand phone	9788 5260
Passenger Service Center	6899 5901

EXIT:

Exit A : Singapore General Hospital (Outram Road)

Exit B : Pearl's Hill City Park, Pearl's Centre, Chinatown

Exit C: Singapore General Hospital (Outram Road)

Exit D: Pearl's Centre, Chinatown, Opp. Dorsett Hotel

LIFT:

Lift 1: Street Level, Platform EWL & Underpass to NEL

PLATFORM

-East Bound (towards Pasir Ris) : Line 1 – Platform A

-West Bound (towards Joo Koon): Line 2 – Platform B

Taxi & General Contacts

Nearby Taxi Stand	Road	Via
Outram Park Station (EWL)	Outram Road	Exit A Exit C

Taxi Services	Booking number
SMRT Taxis	6555 8888
Comfort & City Cab	6552 1111
Trans Cab	6555 3333
Premier Taxis	6363 6888

Hotline	Contact
SMRT Hotline	1800 3368 900
SMRT Press Contact	9822 0902
TransitLink Hotline	1800 2255 663
Transcom Hotline	1800 8420 000

SMRT Online Feedback: www.smrt.com.sg/feedback.aspx



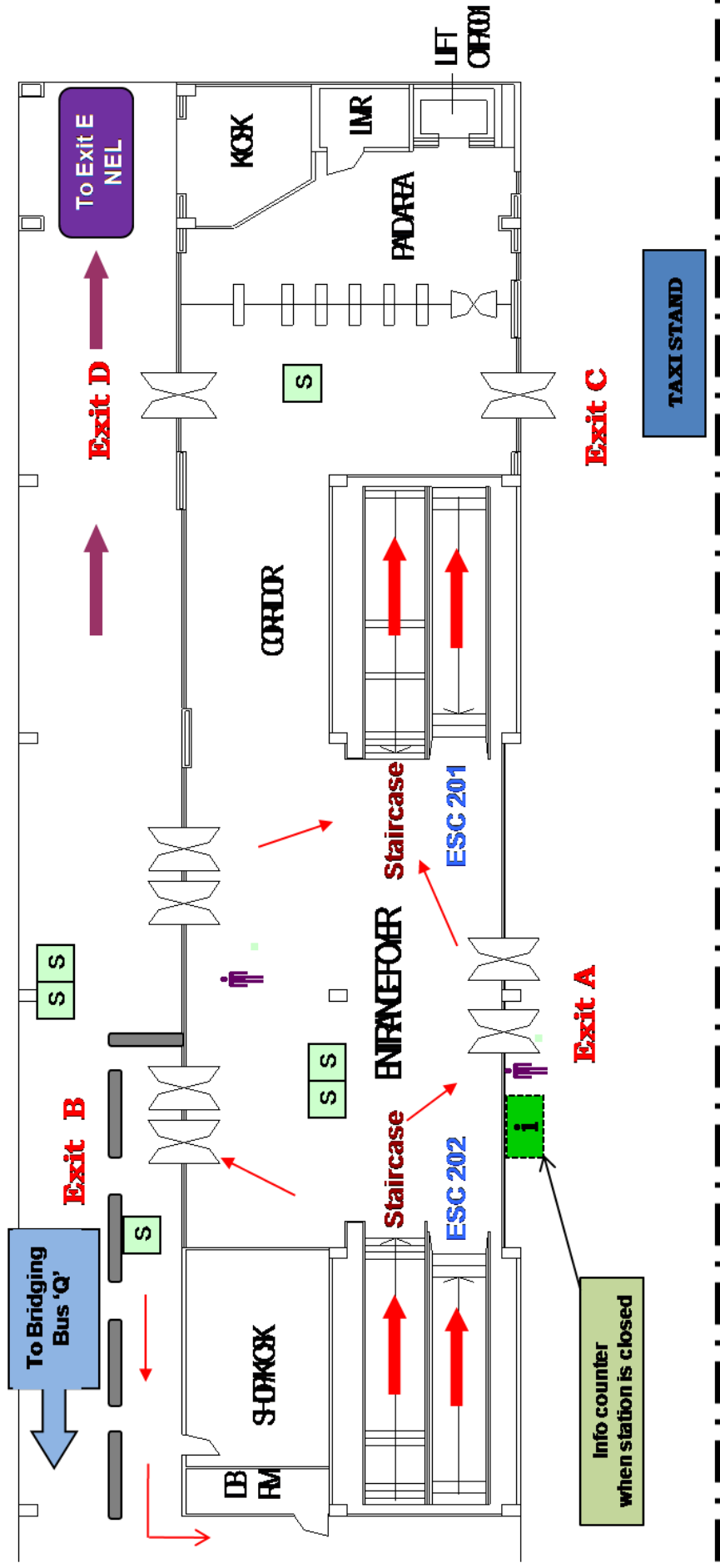

Foyer Level

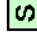

Outram Road

Note: Each main entrance to be manned by 1 CST member when station is close.

LEGEND

-  STAFF
-  CST/SA
-  Signage
-  Info counter
-  Exit route to platform to concourse
-  - To NEL, Ent E

Concourse Level

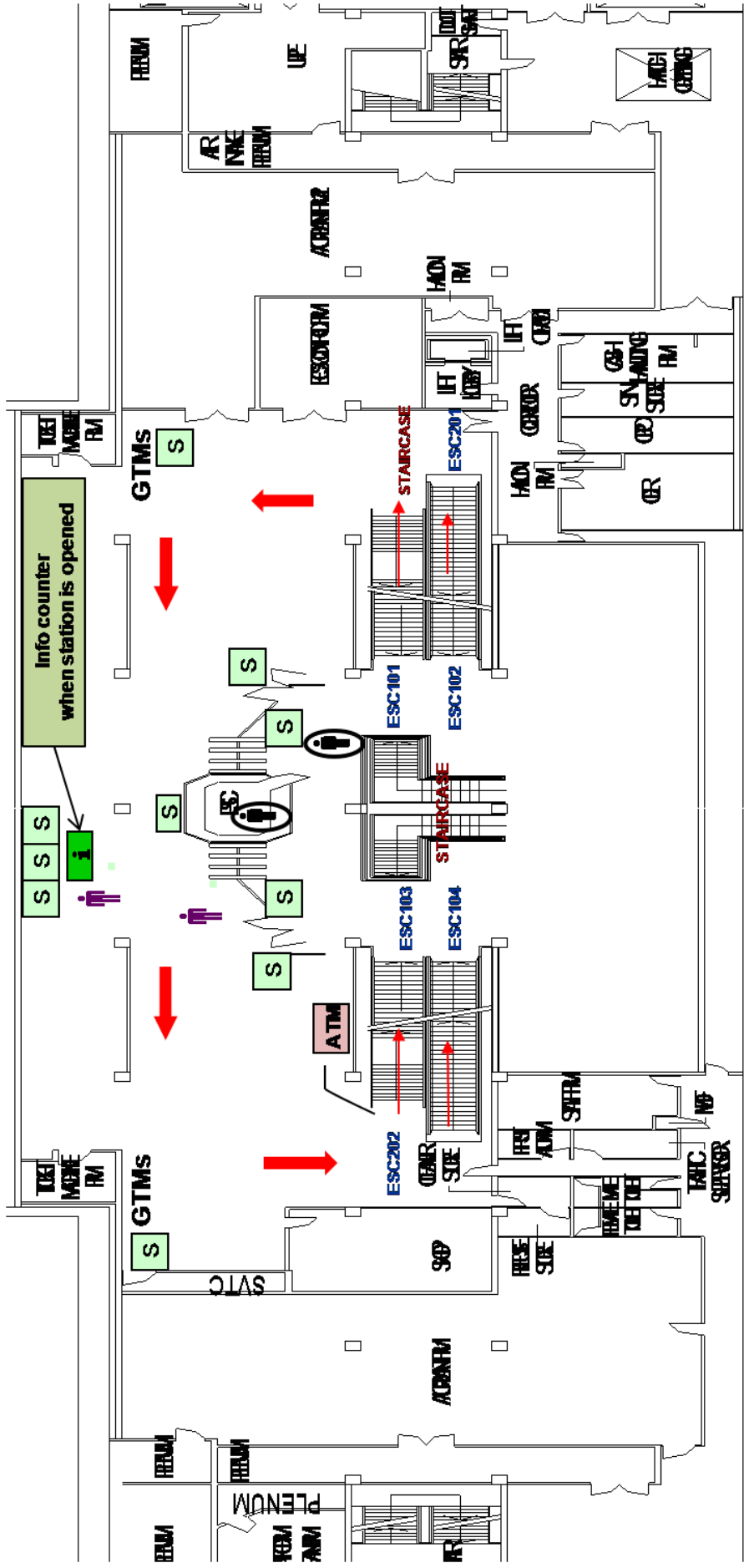

LEGEND

-  STAFF
-  Info counter
-  Signage
-  Exit route to from platform to concourse
-  CST/SA

Platform Level

To be implemented when there are NO train services on both bounds at OTP, EWL. There is however, still a crowd transferring from NEL to OTP EWL.
 - ESC 102 & 104 will be switched to upridding services.

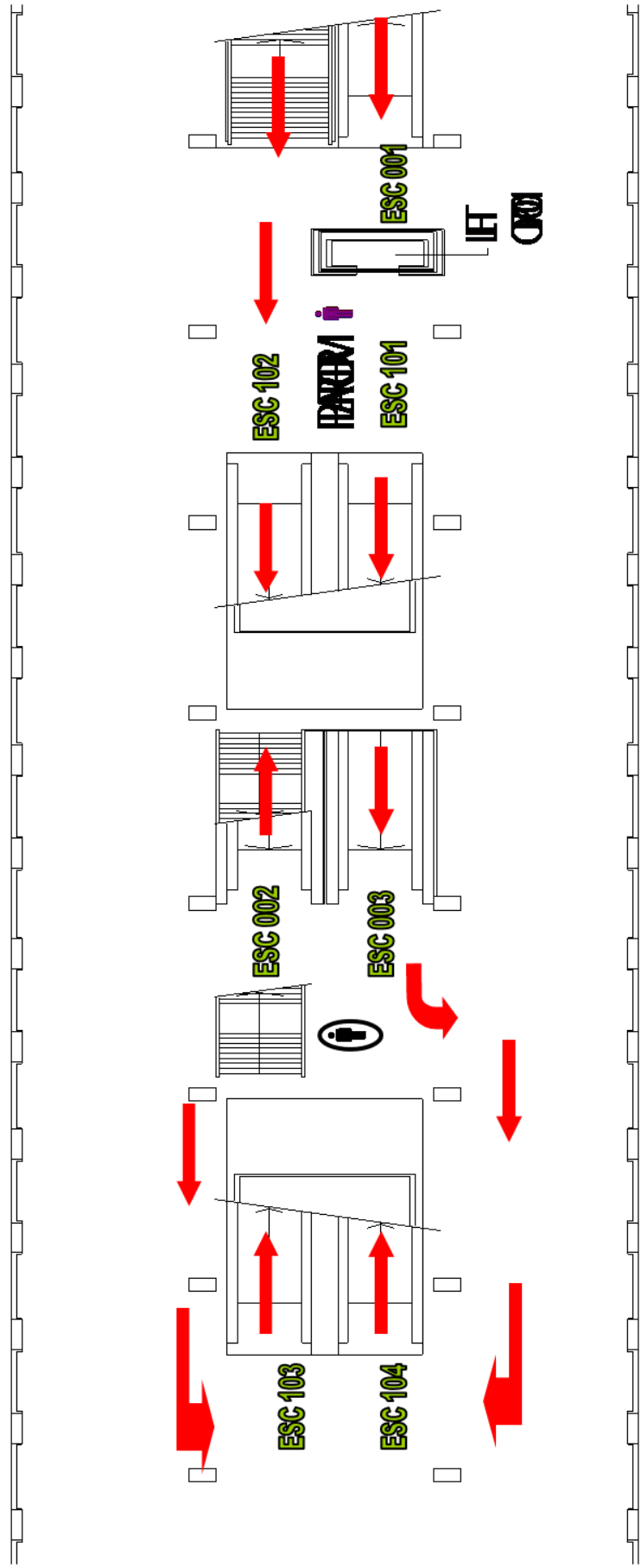

LEGEND

- STAFF
- Info counter
- Exit route to from platform to concourse
- Signage

Linkway

To be implemented when there are NO train services on both bounds at OTP, EWL. There is however, still a crowd transferring from NEL to OTP EWL.

- Appropriate Signages Will Be displayed.
- Foyer AFC Gates will be set in exit mode.
- Passengers travelling to NEL are advised to enter via Exit E (NEL)

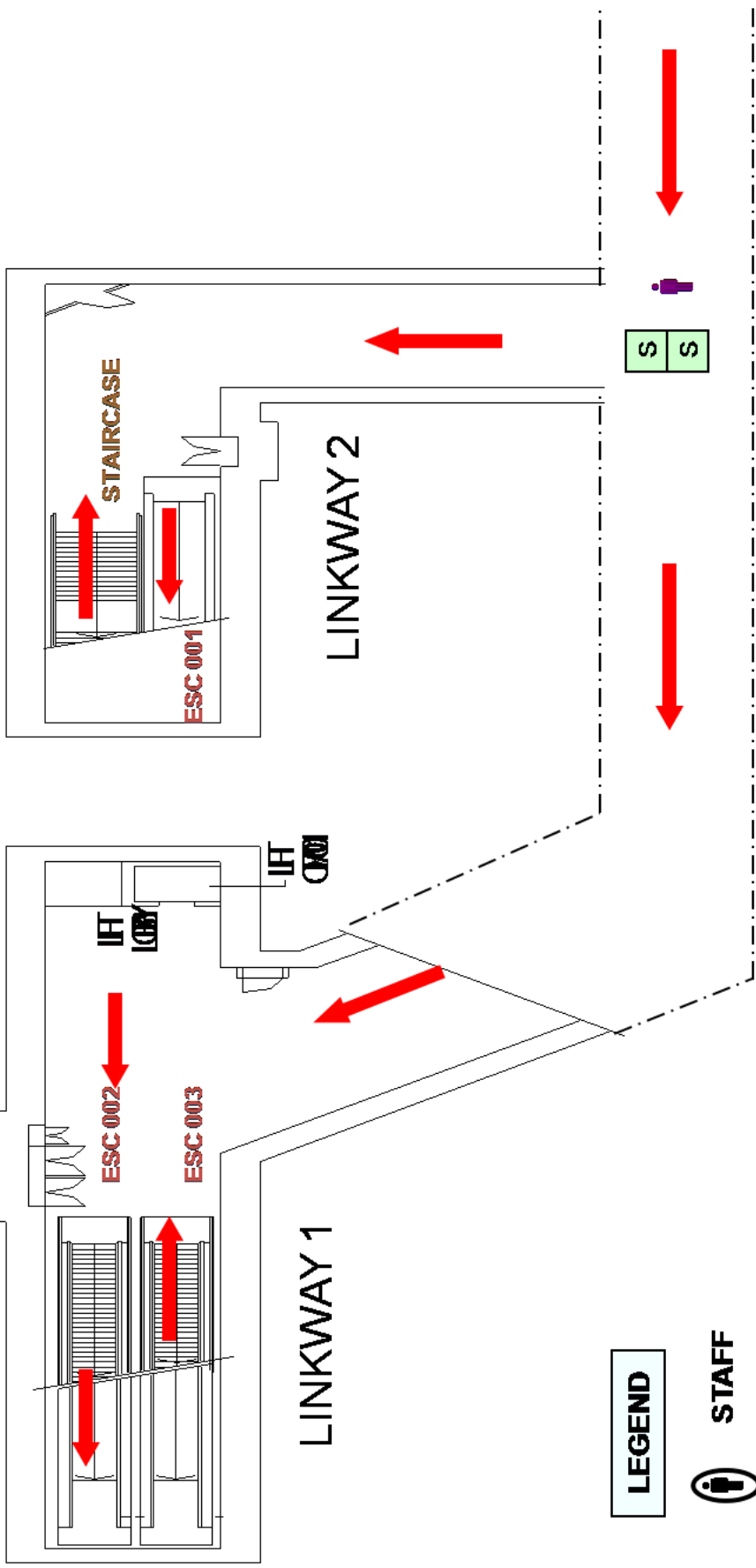

Locality Map

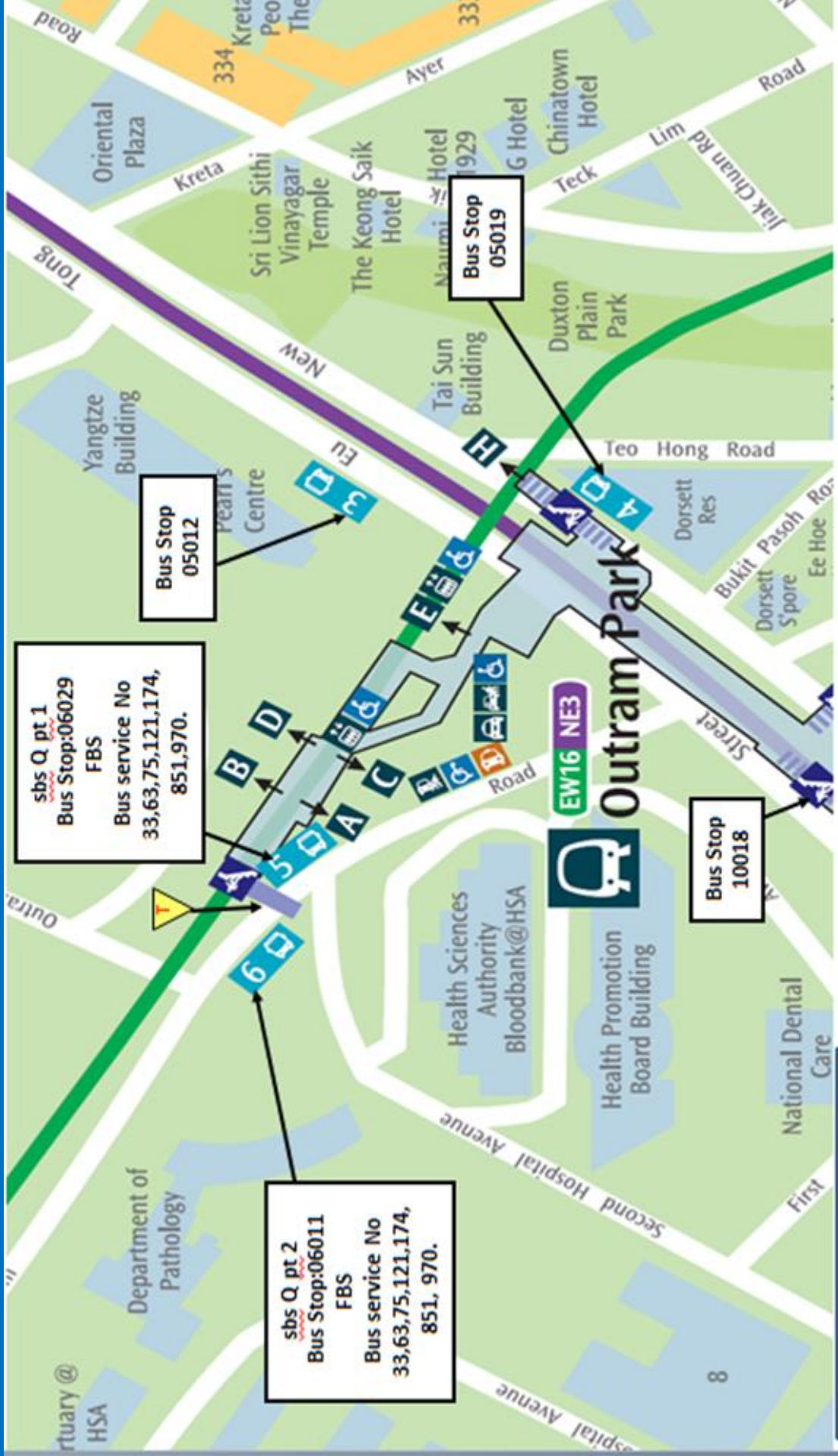

Legend:
 FBS = free regular bus service
 sbs = free shuttle bus service
 T = Special Taxi Pick Up Point*

sbs Pt: Q Pt 1 at Bus Stop 06029 - towards Pasir Ris (East Bound)
 Q Pt 2 at Bus Stop 06011 - towards Joo Koon (West Bound)

* Ahead of normal Taxi stand
 Revision 4 (5/10/15)

Bus Services (By Bus Stop)

FREE Bus Services upon RIMP activation

BUS STOP 06029

Outram Road | via Exit A

33 | 63 | 75 | 121 | 174 | 851 | 970 |

BUS STOP 06011

Singapore General Hospital | Outram Road | via Exit A&B

33 | 63 | 75 | 121 | 174 | 851 | 970 |

Places of Interest

Places of Interest	Via	Places of Interest	Via
Chinatown	Exit B	SingHealth	Exit A
Chinatown Complex Market / Food Centre	Exit B	Polyclinic Outram	
		Dorsett Hotel	Exit B
Health Promotion Board	Exit A		
Health Sciences Authority (Bloodbank@HSA)	Exit A		
Kreta Ayer CC	Exit B		
Kreta Ayer People's Theatre	Exit B		
National Cancer Centre	Exit B		
National Dental Centre	Exit A		
National Heart Centre	Exit B		
Pearl's Centre	Exit B		
Pearl's Hill City Park	Exit B		
Police Cantonment Complex	Exit A		
Singapore General Hospital	Exit B		
Singapore National Eye Centre	Exit B		

Outram Park Station(EW16/NE3)

Train service has been disrupted and we are working to restore normal service as quickly as possible. We apologise for any inconvenience caused.

Alternative Transport

Bus Services from Outram Park to:

Aljunied Station (EW9)	# Bus Stop 06029 (Exit A): 63
Ang Mo Kio Station (NS16)	Bus Stop 05012 (Exit B): 166
Bedok Station (EW5)	# Bus Stop 06029 (Exit A): 33
Bishan Station (NS17/CC15)	Bus Stop 05012 (Exit B): 54
Boon Keng Station (NE9)	Bus Stop 05012 (Exit B): 147
Boon Lay Station (EW27)	# Bus Stop 06011 (Exit A): 174,
Bras Basah Station (CC2)	# Bus Stop 06011 (Exit A): 147,174 # Bus Stop 06029 (Exit A): 851
Bugis Station (EW12/DT14)	# Bus Stop 06029 (Exit A): 33, 63, 851
Bukit Batok Station (NS2)	# Bus Stop 06011 (Exit A): 174
Bukit Merah Bus Interchange	# Bus Stop 06011 (Exit A): 851
Bukit Panjang LRT Station (BP6)	# Bus Stop 06011 (Exit A): 75, 970
Buona Vista Station (EW21/CC22)	Bus Stop 05019 (Exit B): 147
Caldecott Station (CC17)	Bus Stop 05012 (Exit B): 54 # Bus Stop 06029 (Exit A): 851
Chinatown Station (NE4/DT19)	# Bus Stop 06029 (Exit A): 33, 63, 851, 970 Bus Stop 05012 (Exit B): 54, 124, 143, 147, 166, 190
Choa Chu Kang Station (NS4/BP1)	Bus Stop 05012 (Exit B): 190
City Hall Station (NS25/EW13)	# Bus Stop 06029 (Exit A): 63, 851 # Bus Stop 06011 (Exit A): 174 Bus Stop 05012 (Exit A): 147
Clarke Quay Station (NE5)	# Bus Stop 06029 (Exit A): 33, 63, 851 Bus Stop 05012 (Exit B): 54,124,147,166, 190 # Bus Stop 06011 (Exit A): 174
Clementi Station (EW23)	Bus Stop 05019 (Exit B): 147
Commonwealth Station (EW20)	# Bus Stop 06011 (Exit A): 970 Bus Stop 05019 (Exit B): 147. 961

Dhoby Ghaut Station (NS24/NE6/CC1)	# Bus Stop 06011 (Exit A): 174, Bus Stop 05012 (Exit B): 124, 190
Dover Station (EW22)	Bus Stop 05019 (Exit B): 147
Eunos Station (EW7)	# Bus Stop 06029 (Exit A): 63
Farrer Park Station (NE8)	Bus Stop 05012 (Exit B): 147
Farrer Road Station (CC20)	# Bus Stop 06011 (Exit A): 174 Bus Stop 05019 (Exit B): 961
HarbourFront Station (NE1/CC29)	Bus Stop 05019 (Exit B): 143
Haw Par Villa Station (CC25)	Bus Stop 05019 (Exit B): 124, 143
Holland Village (CC21)	# Bus Stop 06011 (Exit A): 970
Hougang Station (NE14)	Bus Stop 05012 (Exit B): 147
Jurong Station (EW24/ NS1)	Bus Stop 05019 (Exit B): 143
Kallang Station (EW10)	# Bus Stop 06029 (Exit A): 33, 63
Kranji Station (NS7)	Bus Stop 05019 (Exit B): 961
Kembangan Station (EW6)	# Bus Stop 06029 (Exit A): 33
Khatib Station (NS14)	# Bus Stop 06029 (Exit A): 851
Labrador Park (CC27)	Bus Stop 05019 (Exit B): 143
Lavender Station (EW11)	# Bus Stop 06029 (Exit A): 33, 63
Little India Station (NE7)	# Bus Stop 06029 (Exit A): 851 Bus Stop 05012 (Exit B): 147, 166
Marsiling Station (NS8)	Bus Stop 05019 (Exit B): 961
Marymount Station (CC16)	# Bus Stop 06029 (Exit A): 851 Bus Stop 05012 (Exit B): 54
Newton Station (NS19)	Bus Stop 05012 (Exit B): 54 Bus Stop 05012 (Exit B): 124, 143
Novena Station (NS20)	# Bus Stop 06029 (Exit A): 851 Bus Stop 05012 (Exit B): 54, 143, 166
Orchard Station (NS22)	# Bus Stop 06011 (Exit A): 174 Bus Stop 05012 (Exit B): 124, 143, 190
Pasir Panjang Station (CC26)	Bus Stop 05019 (Exit B): 143
Petir LRT Station (BP7)	# Bus Stop 06011 (Exit A): 75
Phoenix LRT Station (BP5)	Bus Stop 05012 (Exit B): 190
Potong Pasir Station (NE10)	Bus Stop 05012 (Exit B): 147
Queenstown Station (EW19)	# Bus Stop 06011 (Exit A): 970
Raffles Place Station (NS26/EW14)	# Bus Stop 06029 (Exit A): 75, 970

Redhill Station (EW18)	# Bus Stop 06011 (Exit A): 33, 63, 970
Serangoon Station (NE12/CC13)	Bus Stop 05012 (Exit B): 147
Somerset Station (NS23)	# Bus Stop 06011 (Exit A): 174 Bus Stop 05012 (Exit B): 124, 143, 190
Tanjong Pagar Station (EW15)	# Bus Stop 06029 (Exit A): 75, 970
Telok Blangah Station (CC28)	Bus Stop 05019 (Exit B): 143
Tiong Bahru Station (EW17)	# Bus Stop 06011 (Exit A): 33, 63, 121, 851
Toa Payoh Station (NS19)	Bus Stop 05012 (Exit B): 143
Woodlands Station (N S9)	Bus Stop 05019 (Exit B): 961
Woodleigh Station (NE11)	Bus Stop 05012 (Exit B): 147
Yio Chu Kang Station (NS15)	# Bus Stop 06029 (Exit A): 851
Yishun Station (NS13)	# Bus Stop 06029 (Exit A): 851
# All public bus services at this location are free during Train Service Disruption.	
Taxi Services:	
Nearest Taxi Stand:	Exit A; Outram Road
Taxi Booking Service Hotlines:	SMRT Taxis - 6555 8888 Comfort Taxi - 6552 1111 Trans Cab - 6555 3333 Premier Taxis - 6363 6888
 <p>For information on integrated transportation services, please contact TransitLink Hotline at 1800-225 5663. You can also contact SMRT Customer Relations Centre at 1800-336 8900.</p> <p>有关地铁及巴士路线询问，请拨热线 1800-225 5663 向通联有限公司联络。您也可以联络 SMRT 客户联系中心热线号码 1800-336 8900。</p>	

5. Queue points for free shuttle bus service / special taxi service for student taking major examinations / free regular bus service / bus stops in the vicinity of the station – Outram Park

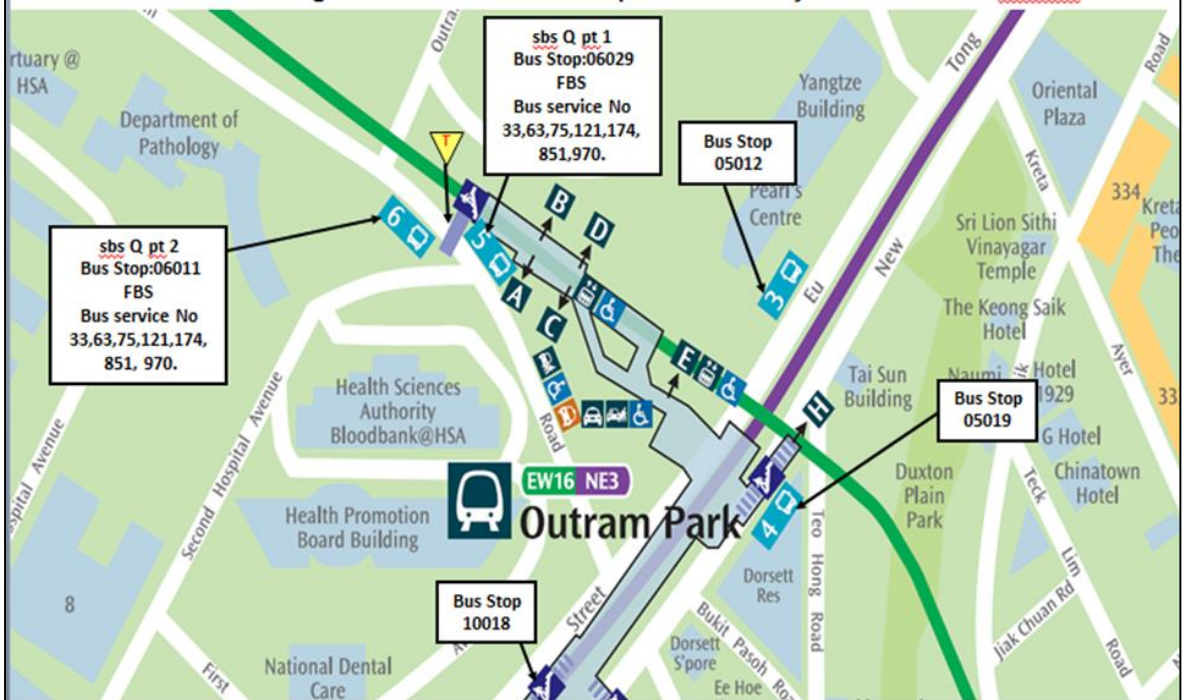

Legend:
 FBS = free regular bus service
 sbs = free shuttle bus service
 = Special Taxi Pick Up Point*

sbs Pt: Q Pt 1 at Bus Stop 06029 - towards Pasir Ris (East Bound)
 Q Pt 2 at Bus Stop 06011 - towards Joo Koon (West Bound)
 * Ahead of normal Taxi stand
 Revision 4 (5/10/15)